

Galaxy Tab 2 Email Setup

Tap the Apps Icon

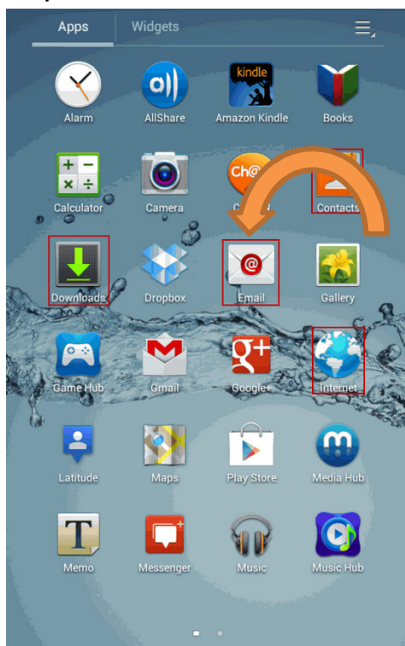

Tap the Email Icon



Tap the Options Icon
Select Settings

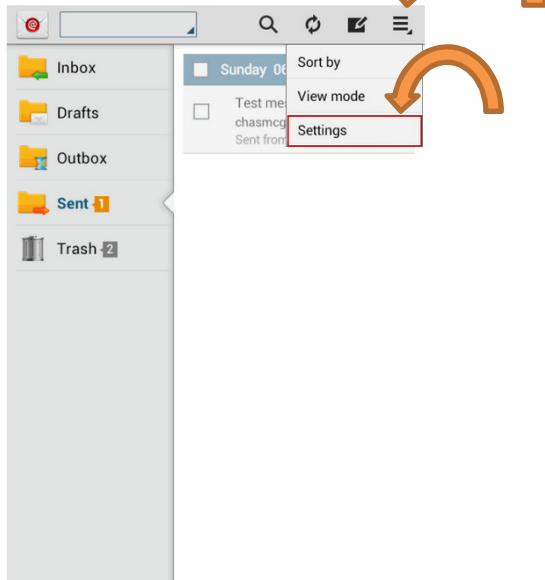

Tap Add account

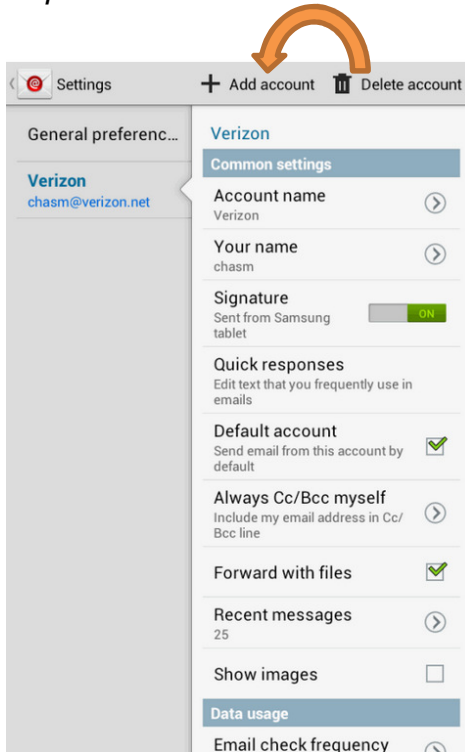

Tap Manual setup

Set up email Manual setup > Next

You can configure email for most accounts in a few steps

chasm@gte.net

.....

Show password



Tap IMAP account

Add email account

What type of account?

POP3 acco

IMAP account

Microsoft Exchange
ActiveSync



Enter your full Email Address as your User name
Type in your password
Under IMAP server enter mail.nwi.net
Set Security type to None
Tap Next

Incoming server settings < Previous > Next

User name
chasm

Password
.....

IMAP server
imap.gte.net

Security type
None

Port
143

IMAP path prefix
Optional

Delete email from server
When I delete from Inbox



Under SMTP server type mail.nwi.net
Set Security type to None
Change the number under Port to 587
Check the box next to Require Sign-in
Enter your Full Email Address as your User name
Type in your Password and tap Next

Outgoing server settings < Previous > Next

SMTP server
outgoing.verizon.net

Security type
None

Port
587

Require sign-in

User name
chasm

Password
.....



*On the next screen you should not need to adjust any settings
Tap Next*

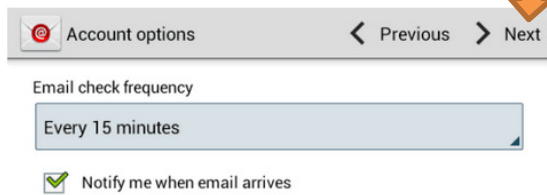

*Enter a description for your email account
Enter your name as it will display on outgoing emails.
Tap Done*

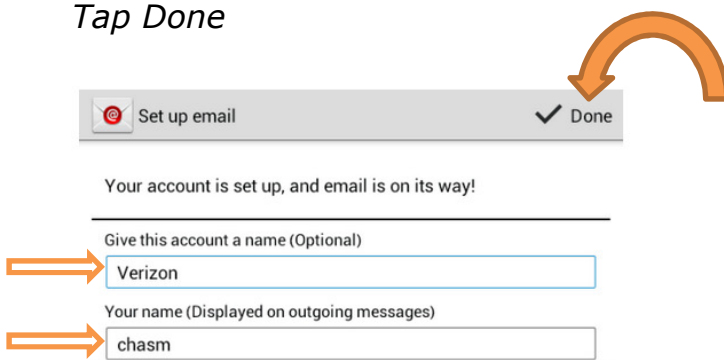

You should now be able to send and receive Email!

